



**20 Kawana Crescent Glen Waverley VIC**

6  4  4 

\*UNFURNISHED

Set on an approximately 704sqm block, this spacious and family friendly house will be sure to impress when you first step in. Spreading across two generous levels, its flexible floor plan offers the perfect balance of privacy and comfort for every member of the family. With six bedrooms, four bathrooms, and three separate living areas, there's no shortage of space to suit everyone's needs and lifestyle.

The north-facing position on the high side of the street ensures plenty of natural light, making the home feel bright and inviting from the moment you walk in. The home also features a mezzanine level that looks down over the lower floor, with large windows that take advantage of the home's

**Type** : House  
**Land Size** : 704 sqm  
**View** : <https://www.melplex.com.au/lease/vic/east/glen-waverley/residential/house/8257823>



**Mark Arnejo**  
**03 9021 0918**

[For full version visit the website](https://www.melplex.com.au)

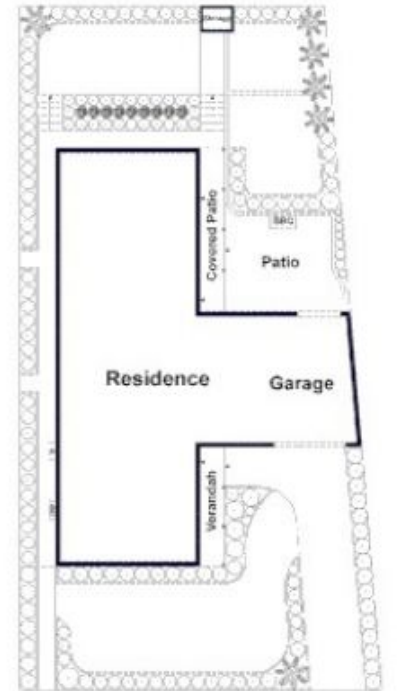
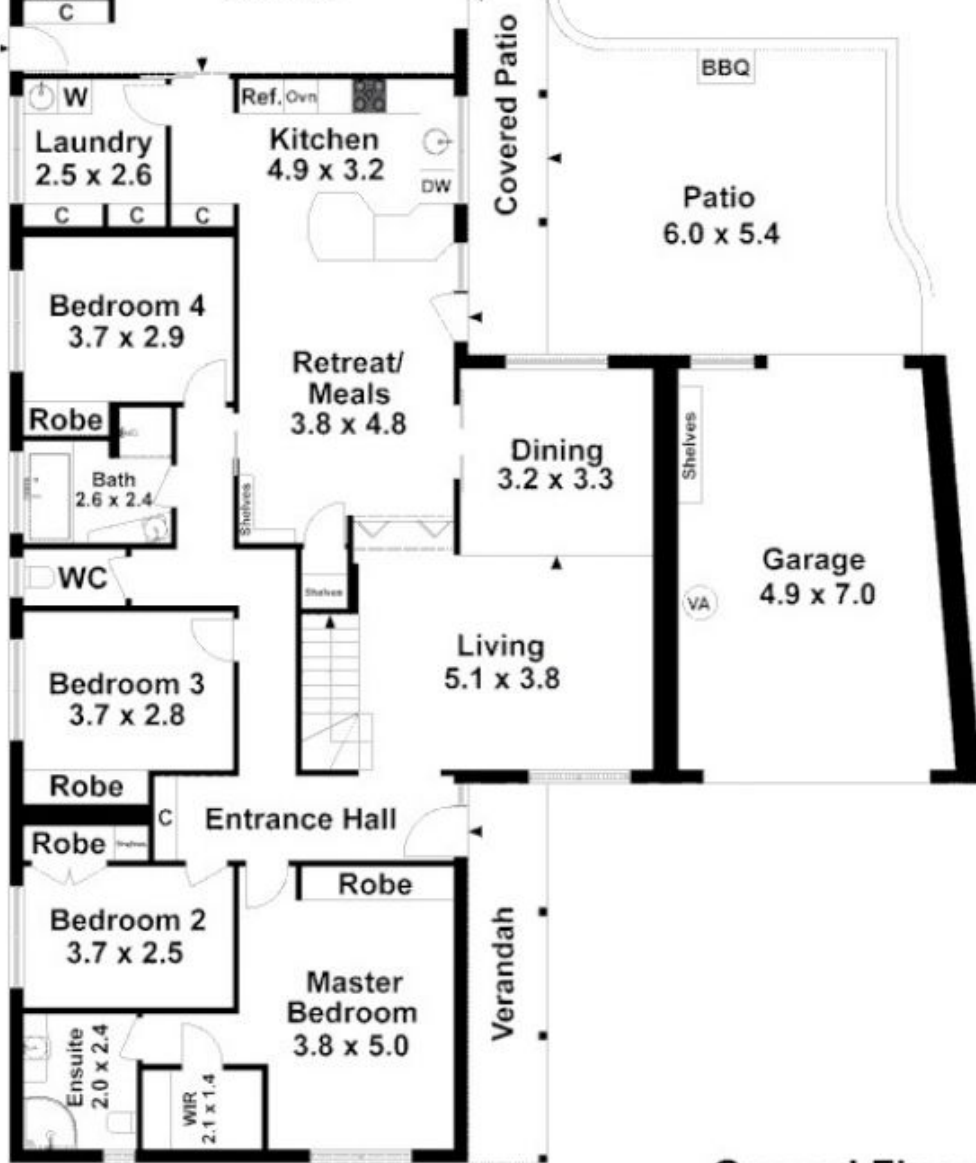

**Ground Floor**

