



406/570 Swanston Street Carlton, VIC

 2  1

## Parkside Living in Melbourne's Academic Zone

Situated opposite Lincoln Park and with walking distance to University of Melbourne. RMIT University and CBD, this lovely apartment is now available for you either to live in or as an exclusive investment always gaining great return.

Sitting on the 4th floor with fantastic natural light, the apartment offers open plan living and meals, kitchen equipped with electric cook tops, central bathroom with shower, two good sized bedrooms, both with mirrored BIRs and a private balcony for outdoor entertainment and abundant fresh air.

Building also includes 24 Security on-site security and community laundry.

With multiply tram lines on your doorsteps or only 15 minute walk to City Central, this ap



**Gerry Wang**

0402 414 065

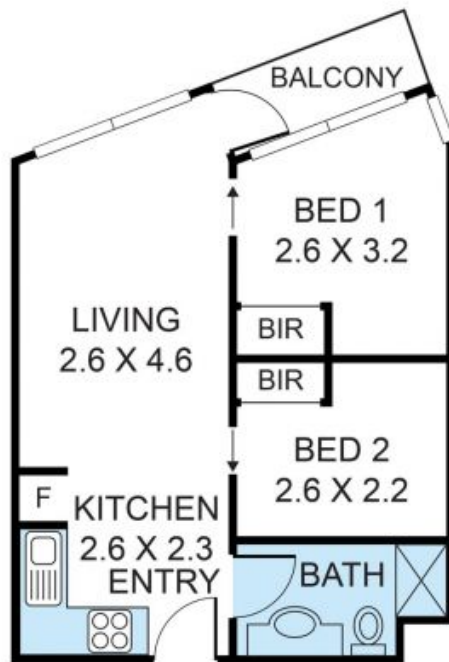

**406/570 Swanston Street, Carlton**

Disclaimer: This floorplan is for illustration purposes only and no warranty is given to its accuracy. Purchasers are advised to carry out their investigations. Produced by [www.realtipsterphotography.com.au](http://www.realtipsterphotography.com.au)