



2/5 Second Street CLAYTON SOUTH, VIC

 3  2.5  1

## LEASED Contemporary Convenience Family Living

\*\*INSPECTION BY APPOINTMENT ONLY.

\*\*Accept 6-month lease.

This contemporary family living is located in a prime location within walking distance to Westall Primary School, Westall Secondary School, Monash Uni, Clayton Road shops, Clayton and Westall Train Stations, parkland and Monash Medical Centre, while moments to IKEA, M-City development and Monash and EastLink Freeways.

Downstairs features an open plan living and dining area flowing outdoor to a private entertainer's courtyard paved for low-maintenance ease, gourmet kitchen with quality stainless steel appliance, stone benches and glass splash back, a powder room and laundry. Upstairs are three robed bedrooms, master with walk-in-robe and ensuite, the other two serviced by



**Melplex Real Estate**

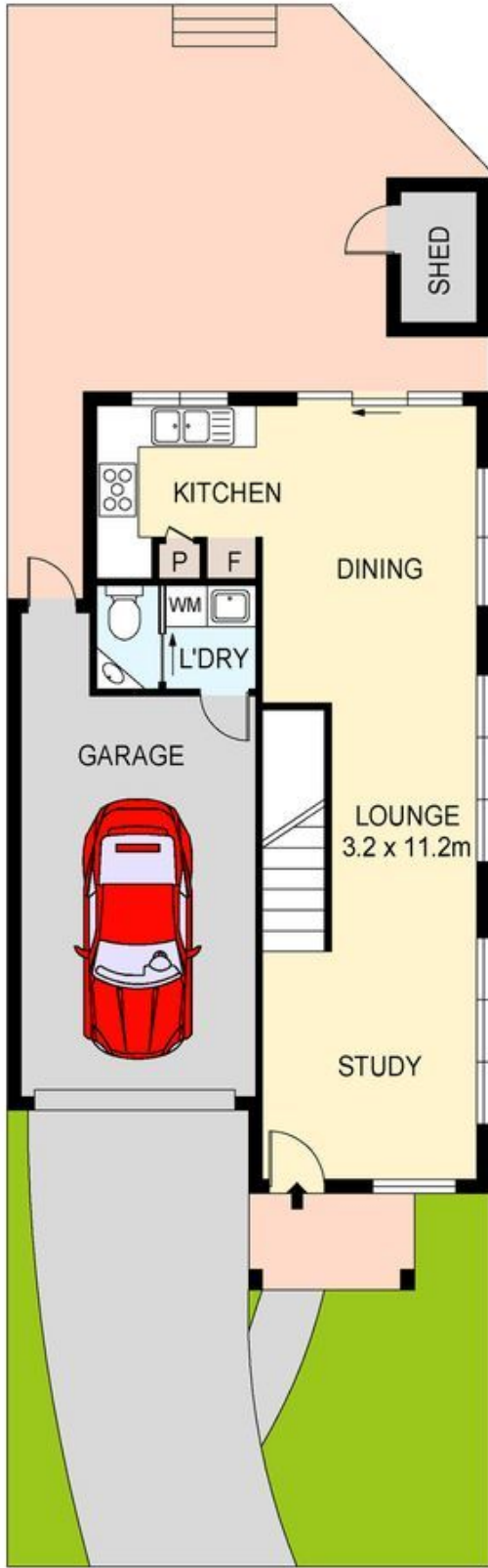

GROUND FLOOR



FIRST FLOOR



Scale in metres. Indicative only. Dimensions are approximate. All information contained herein is gathered from sources we believe to be reliable. However we cannot guarantee its accuracy and interested persons should rely on their own enquiries

Area	M <sup>2</sup>
Living	100



2/5 Second Street, Clayton South **CLAYTON SOUTH, VIC**