



108/39 Earl Street KEW, VIC

 2  2  2

Perfect Package in a Peerless Position

The Earl, a boutique small development in the heart of one of Melbourne's most sought-after inner suburbs, is designed for prestigious urban lifestyle with supreme convenience.

Also features, oak timber flooring, floor to ceiling windows, split system heating/cooling, euro laundry, video intercom and two side by side security car parks and a storage cage.

Suitable for family usage and astute long-term investment.



Gerry Wang

0402 414 065

108/39 Earl Street, Kew

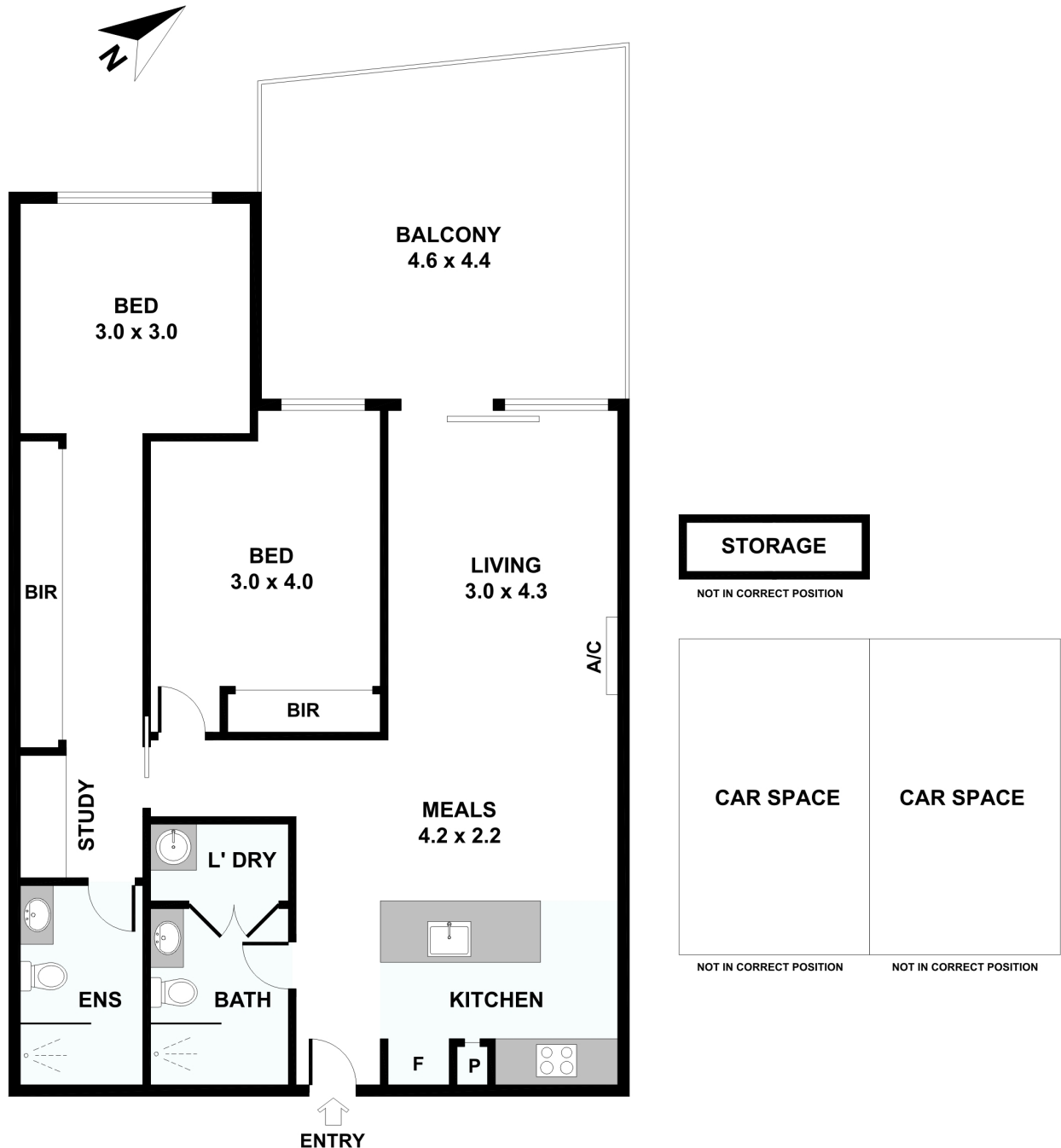

Please note: All stated dimensions are approximate only. Particulars given are for general information only and do not constitute any representation on the part of the vendor or agent.



108/39 Earl Street

KEW, VIC