

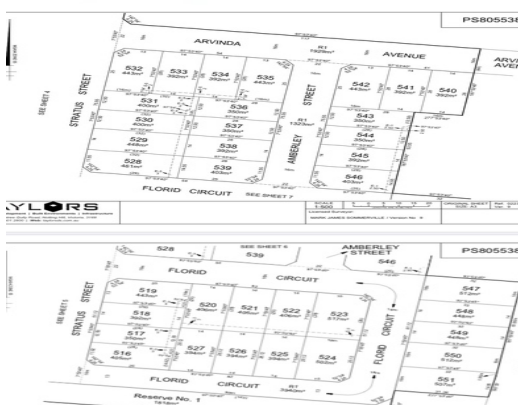

The Park Precinct  
Lots from 294m<sup>2</sup> - 499m<sup>2</sup>  
MARCH 2018



### Stage 5 Grand Central TARNEIT, VIC

### BIG DISCOUNT LAND SALE in Grand Central Estate Tarneit!!!?

THREE BLOCKS OF LAND for sale, great opportunity for a first home buyer or investor to secure a block of land with a great frontage. This gem is situated in one of the most sought after Estates in Tarneit.?

Lot.533: 392sqm, facing to park. original contract price is \$340,000. 5% off now.

Lot.536: 350sqm, original contract price is \$304,000. 5% off now.

Lot.538: 392sqm, original contract price is \$321,000. 5% off now.??

The land is close to:??



Melpex Real Estate