



1106/31 A'Beckett Street MELBOURNE, VIC

 2  1

Partially Furnished 2 Bed Apartment in Prime Position

Situated right in the heart Melbourne's CBD and well within walking distances to Melbourne Central, Melbourne Uni, RMIT, Victoria Market and all the Elizabeth St shopping precincts, not to mention multiple public transport access in the free tram zone.

The apartment comprises a flexible floor plan with open plan living and meals, two good sized bedrooms, both with BIRs, stylish bathroom with laundry facility as well as a Euro kitchen with gas cook top and stainless steel appliances.

****Photos are for advertising purposes only****

****Bond is six weeks' rental****

*****Note: Due to the rapidly evolving COVID-19, all clients must register with agent prior**



Melplex Real Estate

**TYPE-E
LEVEL 10-11**

TYPICAL LOT
• 2 Bedrooms

- ROOMS**
- Master Bedroom
 - Bedroom 2
 - Bathroom
 - Living/Kitchen/Dining

AREAS

LEVEL 10

- APT 05: Internal 45.7sqm + Terrace 0sqm = Total 45.7sqm
- APT 06: Internal 45.7sqm + Terrace 0sqm = Total 45.7sqm
- APT 07: Internal 45.7sqm + Terrace 0sqm = Total 45.7sqm
- APT 08: Internal 45.7sqm + Terrace 0sqm = Total 45.7sqm
- APT 09: Internal 45.7sqm + Terrace 0sqm = Total 45.7sqm

LEVEL 11-11

- APT 04: Internal 45.7sqm + Terrace 0sqm = Total 45.7sqm
- APT 05: Internal 45.7sqm + Terrace 0sqm = Total 45.7sqm
- APT 06: Internal 45.7sqm + Terrace 0sqm = Total 45.7sqm
- APT 07: Internal 45.7sqm + Terrace 0sqm = Total 45.7sqm
- APT 08: Internal 45.7sqm + Terrace 0sqm = Total 45.7sqm

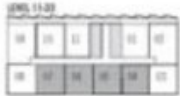

PAN URBAN

A'Beckett Tower

DESIGNED BY MELPEX ARCHITECTURE AND INTERIOR DESIGN
CONSTRUCTION BY THE BUILDING GROUP
PHOTOGRAPHY BY ANDREW HARRISON FOR MELPEX 