

3214/160 Victoria Street CARLTON, VIC

 2  2

## Brand New 2-bed 2-bath Apartment in Swanston Central

Conveniently located on the corner of Victoria and Bouverie Streets, Swanston Central has already been recognised as one of the most popular occupancy targets, which connects Carlton and Melbourne CBD by simply a street.

Located on 32nd floor with fantastic views, this spacious 2-bed 2-bath apartment comprised open plan living, stylish Euro kitchen with stone island bench and stainless steel appliances, master with ensuite, second double bedroom, both with own windows and BIRs.

The apartment includes highest quality features and finishes, air-conditioning and intercom system.

Swanton Central includes six star facilities, such as Central Club Lounge, luxury lap pool



**Melplex Real Estate**

APARTMENT TYPE B16.1

2 bed  
2 bath

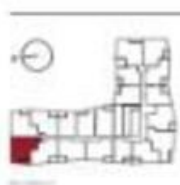

INTERNAL AREA	63.0m <sup>2</sup>
W/OUT TERRACE AREA	1.2m <sup>2</sup>
TOTAL AREA	64.2m <sup>2</sup>

This plan is prepared for the completion of the design, engineering and construction documents. It is subject to a professional engineer's approval and is not to be used for any other purpose without the consent of the engineer. The plan is subject to change without notice and is not to be used for any other purpose without the consent of the engineer.

