



Level 12/224 La Trobe Street MELBOURNE, VIC

 1  1

Aurora Opportunity in the Heart of Melbourne

-----Nominee Sale-----



Aurora, the highest Iconic Building in Melbourne, is strategically situated in the middle of La Trobe St, with direct connect to Melbourne Central Shopping Centre, Emporium, Bourke St, Mall and only about a few minute walk to State Library, RMIT, Melbourne Uni and well within the Free Tram Zone.

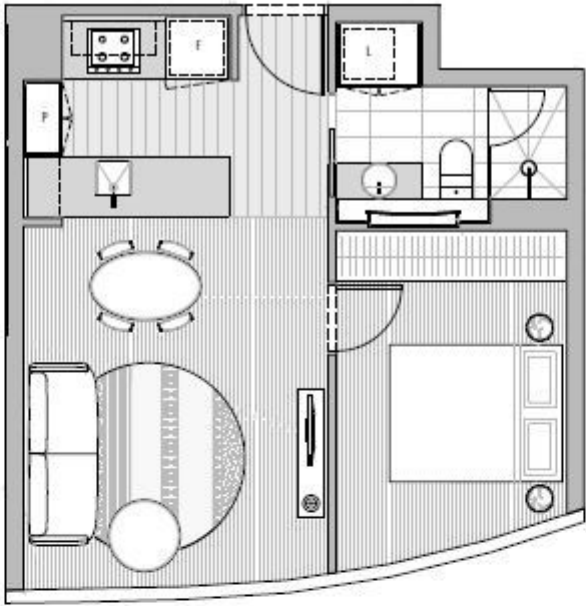

Gerry Wang

0402 414 065

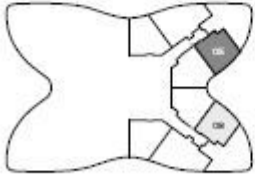

LEVEL 10-32		UNIT 05 & 08	
LITTLE LA TROBE STREET			
			
LA TROBE STREET			
			
1 BEDROOM / 1 BATHROOM			
APARTMENT		42.9m ²	
BALCONY		0.0m ²	
TOTAL		42.9m²	