



1309/31 A'Beckett Street MELBOURNE, VIC

 2  1  1

Position Perfect in the Heart of Academic Zone

As a modern apartment in the absolute centre of Melbourne CBD, 1309 is situated on the North-Western corner of 13th floor on this most sought after residential building, with walking distances to almost everything you need for an urban lifestyle lover.

Comprising open plan living and meals, two good sized bedrooms, both with BIRs, stylish bathroom with laundry facility as well as a Euro kitchen with gas cook top and stainless steel appliances, decent sized balcony with Northerly natural light and overlooking the campus of RMIT.

Situated right in the heart Melbourne's CBD and well within walking distances to Melbourne Central, Melbourne University, RMIT, Queen Victoria Market and all the Elizabeth St shops, restaurants and cafes, not to mention multiple public transport access to all direction right at your doorstep, the property has a complete package which will suit first home buy



Gerry Wang

0402 414 065

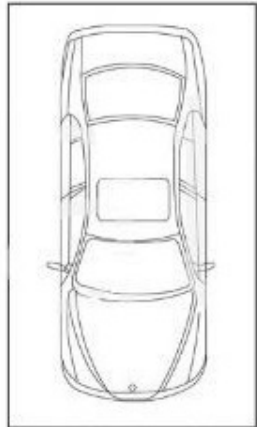
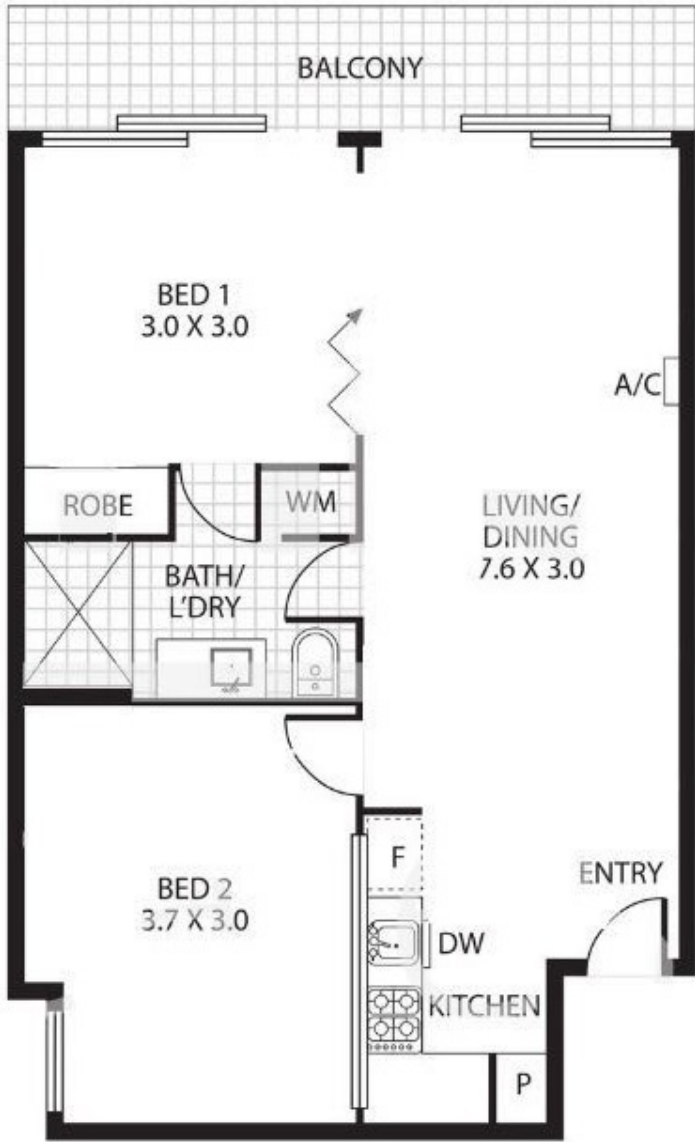

(NOT IN POSITION)

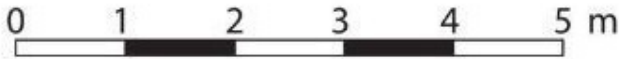

Scale in metres. Indicative Only.
 Dimensions are all approximate.
 All information contained herein is gathered from sources we believe to be reliable. However we cannot guarantee its accuracy and interested parties should rely on their own enquiries.

Residence - 51 SQ M APPROX.

Balcony - 8 SQ M APPROX.